

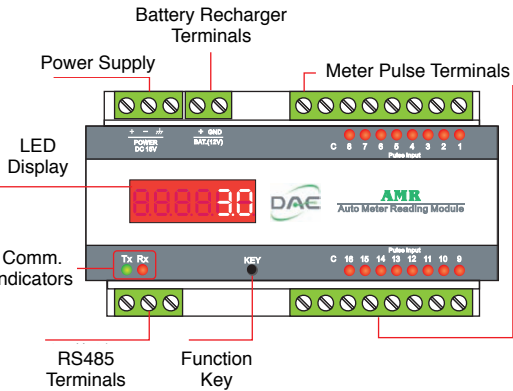

AMR

Installation Guide

1 Front Panel



2 Dimensions

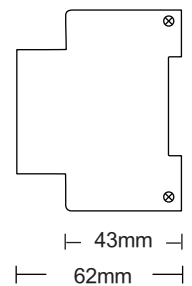
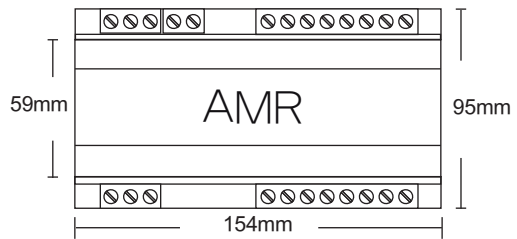

Weight: 343g

3 Mounting

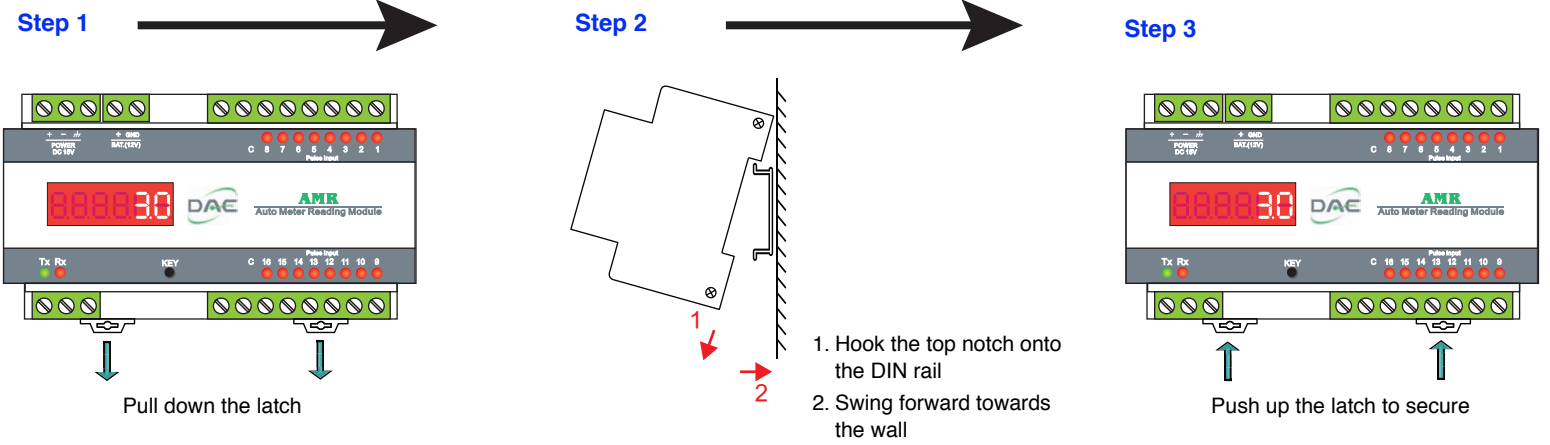

4 Wiring Diagram

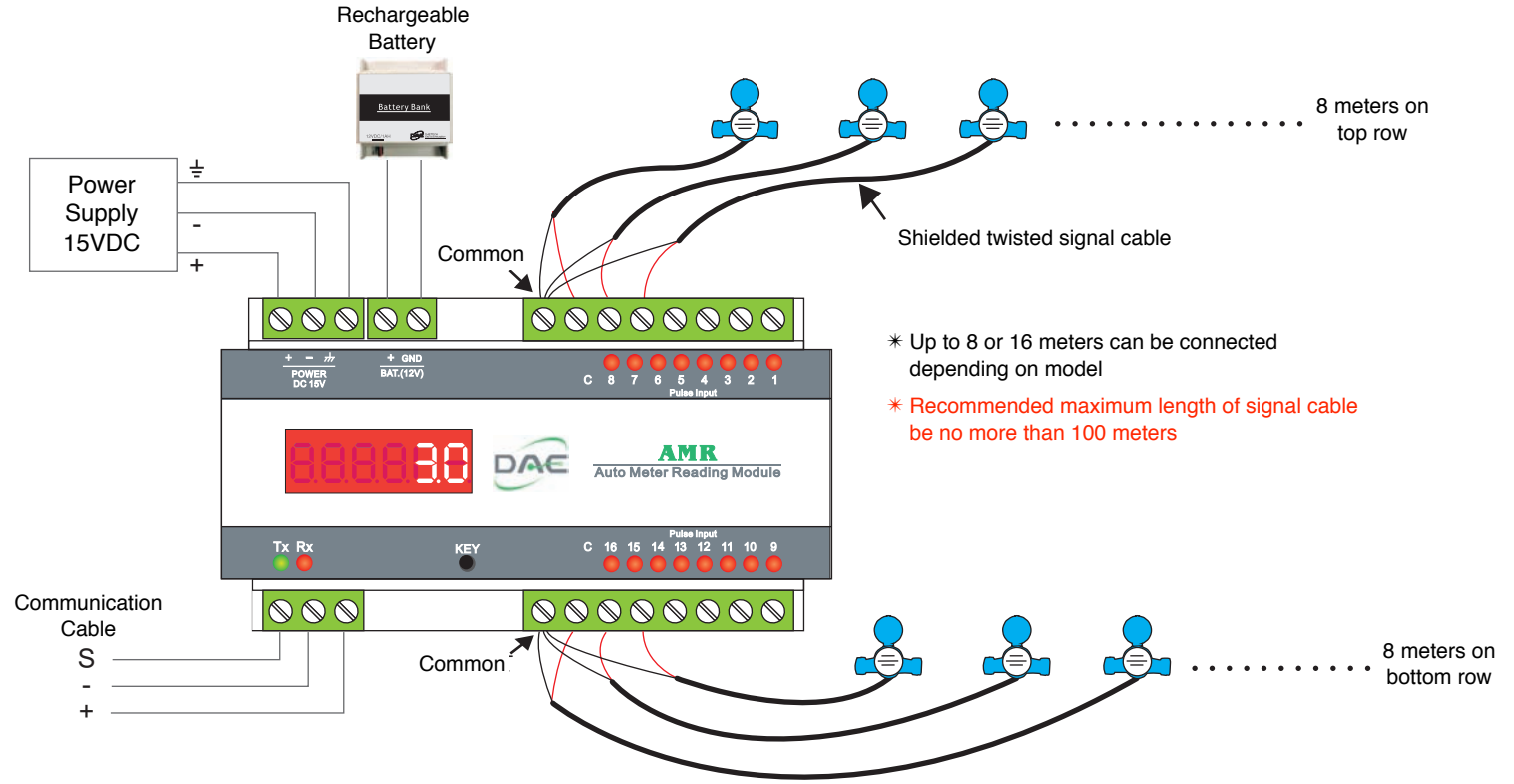

5 Terminal Wiring Detail

Power

Recommended:
Use 16~24 AWG wire with European Style Terminator

* Note the polarity

Battery Charger

Recommended:
Use 16~24 AWG wire with European Style Terminator

Meter Pulse Signal

Recommended:
Use 16~24 AWG wire with European Style Terminator

RS485 Communication

* Note the polarity

Recommended:
Use 16~24 AWG wire with European Style Terminator

Tie ground wires and wrap together

Shielded and twisted signal cable

6 Setup

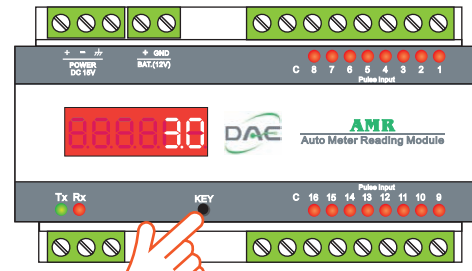

* Long press means to press and hold the function key for 2 seconds or more

Long press to enter setup mode

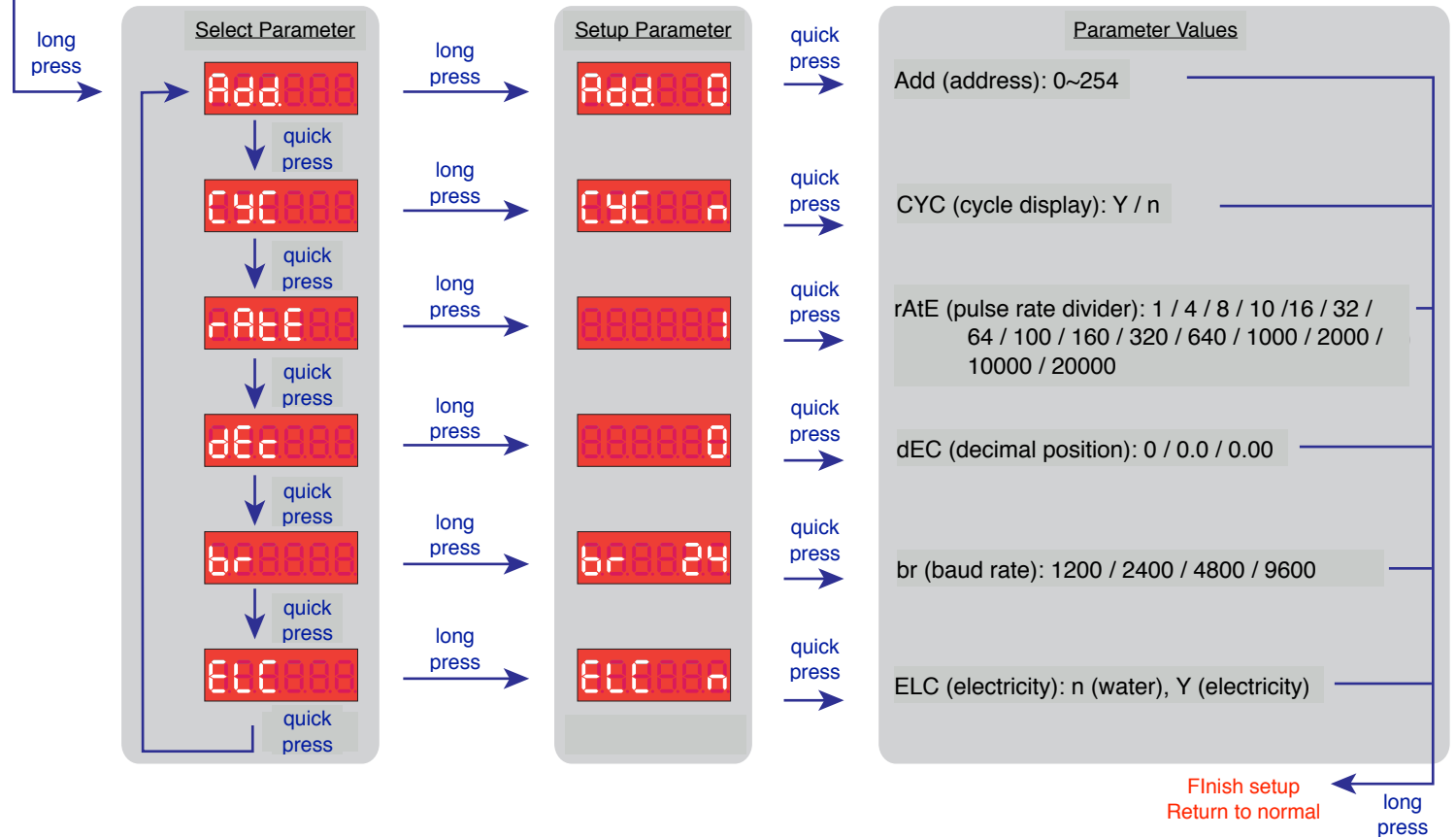

7 Normal Display

During normal operation, the display will show the channel number and its accumulated pulses. The accumulated pulses is the value after being divided by the pulse rate divider. The decimal position is cosmetic only and is used to make the displayed value more palatable to the operator.

1. Select Channel To Display

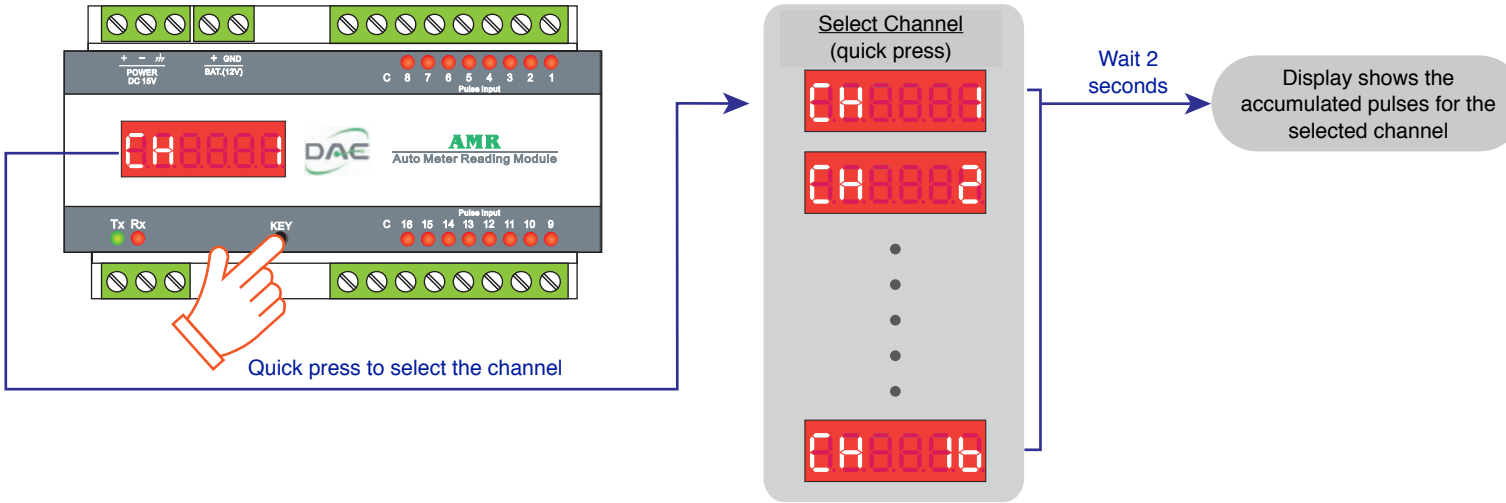

2. Display Cycles Among All Channels

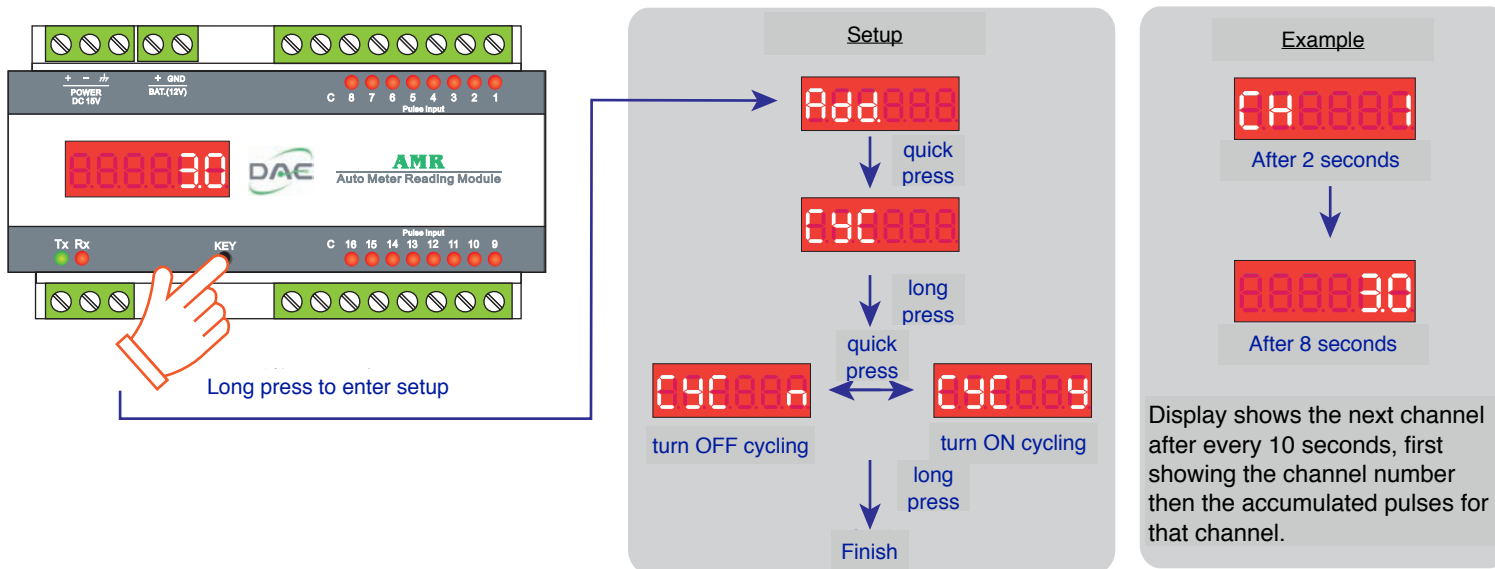

8 Warnings & Precautions

⚠ Danger

To prevent electric shock, turn off all sources of electrical power to the device during installation or wiring.

⚠ Warning

- Install only by a qualified and trained personnel.
- Follow these instructions accordingly, otherwise damage may occur to the device.
- Follow electrical rules and regulations in the selection of wire materials and gauges.
- Avoid having oil, water, metallic powder or other foreign substances enter the device.
- Avoid using the device in environments where it will be exposed to steam, corrosive, or flammable substances; which can cause short circuits, fires, or explosions.

